



Electrofusion Transition Saddles

PE4710 / PE100 2" IPS-12" IPS or DIPS



Plasson EF Transition (Corp) Saddles. Available in sizes from 2" IPS to 12" IPS or DIPS with 1" or 2" NPT or CORP Brass Threaded Outlets.

Plasson USA Electrofusion Fittings are specifically designed for reliable, high performance pipe joining and long system life. The Plasson automated Electrofusion system has been proven to be the most economical due to the low potential for operator error.

Plasson USA Electrofusion Branch Saddles are supplied with a dedicated strap/clamp to assure proper compression during the fusion process. They are designed, tested and quality controlled in accordance with Plasson's internal standards. Plasson USA Electrofusion Fittings meet or exceed the following standards:

- ASTM D2513
- ASTM F2897
- ISO 14236
- FM 1613 (FM Approved Fittings Only)
- ASTM F1055
- ISO 8085
- AWWA C906,
- NSF 61



INDUSTRIAL



GAS



MINING



WATER



FIRE
PROTECTION



LANDFILL

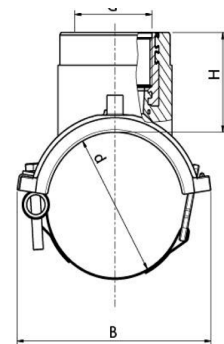
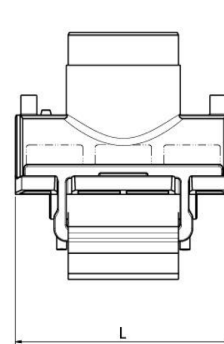

PRODUCT DATA

PRODUCT CODE	PRODUCT DESCRIPTION	PRIMARY DIMENSION	SECONDARY DIMENSION	PRESSURE RATING WATER	FITTING RAW MATERIAL	AMBIENT FUSION TEMPERATURE
5938	Transition Saddle	2" IPS-12" IPS or DIPS	1" NPT / 1" CORP 2" NPT / 2" CORP	200 PSI	PE 4710/PE 100/ Red Brass	14 - 113°F

www.PlassonUSA.com

Plasson USA | 305 N 7th St., Corsicana, TX 75110 | 800-241-4175
Stafford, TX | Missoula, MT | Corsicana, TX

DIMENSIONS

ITEM NUMBER	MAIN PIPE SIZE d	OUTLET SIZE dl	d		B		G		L		H		W	
			(inch)	(mm)	(inch)	(mm)	(inch)	(mm)	(inch)	(mm)	(lbs)	g	(lbs)	g
5938B00302045	2 IPS	1"NPT	2.3	60.4	3.93	100	1.24	31.5	4.65	118.1	1.15	29.4	1.41	640
5938B00303045	3 IPS	1"NPT	3.5	88.9	5.38	136.8	1.24	31.5	6.93	176.0	1.65	42.0	2.05	930
5938B00303045	4 IPS	1"NPT	4.5	114.3	6.15	156.3	1.24	31.5	6.93	176.0	1.65	42.0	2.06	935
5938D00304045	4 DIPS	1"NPT	4.97	121.9	6.5	165.3	1.24	31.5	6.93	176.0	1.65	42.0	2.07	940
5938B00306045	6 IPS	1"NPT	6.6	168.3	6.84	173.8	1.24	31.5	6.93	118.1	1.65	42.0	2.06	935
5938D00306045	6 DIPS	1"NPT	6.9	175.3	6.96	176.9	1.24	31.5	6.93	176.0	1.65	42.0	2.06	935
5938B00308045	8 IPS	1"NPT	8.6	219.1	7.08	179.8	1.24	31.5	6.93	176.0	1.65	42.0	2.07	940
5938B00308045	8 DIPS	1"NPT	9.05	229.9	7.08	179.8	1.24	31.5	6.93	176.0	1.65	42.0	2.07	940
5938B00310045	10 IPS	1"NPT	10.75	273.1	7.1	180.5	1.24	31.5	6.93	176.0	1.65	42.0	2.08	945
5938D00310045	10 DIPS	1"NPT	11.1	281.9	7.1	180.5	1.24	31.5	6.93	176.0	1.65	42.0	2.09	950
5938B01312045	12 IPS	1"NPT	12.75	324.0	7.67	195	1.24	31.5	6.93	176.0	1.65	42.0	2.09	950
5938D01312045	12 DIPS	1"NPT	13.20	335.3	7.67	195	1.24	31.5	6.93	176.0	1.65	42.0	2.09	950
5938B00302060	2 IPS	1"CORP	2.3	60.4	3.93	100	1.36	34.5	4.65	118.1	1.15	29.4	1.46	665
5938B00303060	3 IPS	1"CORP	3.5	88.9	5.38	136.8	1.36	34.5	6.93	176.0	1.65	42.0	2.08	945
5938B00304060	4 IPS	1"CORP	4.5	114.3	6.15	156.3	1.36	34.5	6.93	176.0	1.65	42.0	2.08	945
5938D00304060	4 DIPS	1"CORP	4.97	121.9	6.5	165.3	1.36	34.5	6.93	176.0	1.65	42.0	2.09	950
5938B00306060	6 IPS	1"CORP	6.6	168.3	6.84	173.8	1.36	34.5	6.93	176.0	1.65	42.0	2.09	950
5938D00306060	6 DIPS	1"CORP	6.9	175.3	6.96	176.9	1.36	34.5	6.93	176.0	1.65	42.0	2.1	955
5938B00308060	8 IPS	1"CORP	8.6	219.1	7.08	179.8	1.36	34.5	6.93	176.0	1.65	42.0	2.11	960
5938D00308060	8 DIPS	1"CORP	9.05	229.1	7.08	179.8	1.36	34.5	6.93	176.0	1.65	42.0	2.11	960
5938B00310060	10 IPS	1"CORP	10.75	273.1	7.1	180.5	1.36	34.5	6.93	176.0	1.65	42.0	2.12	965
5938D00310060	10 DIPS	1"CORP	11.1	281.9	7.1	180.5	1.36	34.5	6.93	176.0	1.65	42.0	2.13	970
5938B01312060	12 IPS	1"CORP	12.75	324.0	7.67	195	2.58	65.5	6.93	176.0	1.84	46.7	2.09	950
5938D01312060	12 DIPS	1"CORP	13.20	335.3	7.67	195	2.58	65.5	6.93	176.0	1.84	46.7	2.09	950
5938B00303055	3 IPS	2"NPT	3.5	88.9	5.38	136.8	2.29	58.2	6.93	176	1.84	46.7	2.31	1050
5938B00304055	4 IPS	2"NPT	4.5	114.3	6.15	156.3	2.29	58.2	6.93	176	1.84	46.7	2.33	1060
5938D00304055	4 DIPS	2"NPT	4.97	121.9	6.5	165.3	2.29	58.2	6.93	176	1.84	46.7	2.35	1065
5938B00306055	6 IPS	2"NPT	6.6	168.3	6.84	173.8	2.29	58.2	6.93	176	1.84	46.7	2.36	1070
5938D00306055	6 DIPS	2"NPT	6.9	175.3	6.96	176.9	2.29	58.2	6.93	176	1.84	46.7	2.37	1075
5938B00308055	8 IPS	2"NPT	8.6	219.1	7.08	179.8	2.29	58.2	6.93	176	1.84	46.7	2.40	1090
5938D00308055	8 DIPS	2"NPT	9.05	229.9	7.08	179.8	2.29	58.2	6.93	176	1.84	46.7	2.42	1100
5938B00310055	10 IPS	2"NPT	10.75	273.1	7.1	180.5	2.29	58.2	6.93	176	1.84	46.7	2.45	1110
5938D00310055	10 DIPS	2"NPT	11.1	281.9	7.1	180.5	2.29	58.2	6.93	176	1.84	46.7	2.46	1115
5938B01312055	12 IPS	2"NPT	12.75	324.0	7.67	195	2.29	58.2	6.93	176	1.84	46.7	2.45	1110
5938D01312055	12 DIPS	2"NPT	13.20	335.3	7.67	195	2.29	58.2	6.93	176	1.84	46.7	2.46	1115
5938B00304070	4 IPS	2"CORP	4.5	114.3	6.15	156.3	2.58	65.5	6.93	176	1.84	46.7	2.57	1165
5938D00304070	4 DIPS	2"CORP	4.97	121.9	6.5	165.3	2.58	65.5	6.93	176	1.84	46.7	2.60	1175
5938B00306070	6 IPS	2"CORP	6.6	168.3	6.84	173.8	2.58	65.5	6.93	176	1.84	46.7	2.60	1175
5938D00306070	6 DIPS	2"CORP	6.9	175.3	6.96	176.9	2.58	65.5	6.93	176	1.84	46.7	2.60	1175
5938B00308070	8 IPS	2"CORP	8.6	219.1	7.08	179.8	2.58	65.5	6.93	176	1.84	46.7	2.61	1185
5938D00308070	8 DIPS	2"CORP	9.05	229.9	7.08	179.8	2.58	65.5	6.93	176	1.84	46.7	2.65	1200
5938B00310070	10 IPS	2"CORP	10.75	273.1	7.1	180.5	2.58	65.5	6.93	176	1.84	46.7	2.66	1210
5938D00310070	10 DIPS	2"CORP	11.1	281.9	7.1	180.5	2.58	65.5	6.93	176	1.84	46.7	2.67	1215
5938B01312070	12 IPS	2" CORP	12.75	324.0	7.67	195	2.58	65.5	6.93	176	1.84	46.7	2.45	1110
5938D01312070	12 DIPS	2" CORP	13.20	335.3	7.67	195	2.58	65.5	6.93	176	1.84	46.7	2.46	1115