

ELECTROFUSION COUPLINGS



PE4710 / PE100

1/2" IPS" - 30" IPS

40 Volts, 4.0MM Pin with Universal Barcode

*Fusion and Cooling times are clearly marked on the barcode of every fitting.
This information may also be obtained with the barcode reader.*

Plasson USA Electrofusion Fittings are specifically designed for reliable, high performance pipe joining and long system life. The Plasson automated Electrofusion system has been proven to be the most economical due to the low potential for operator error.

Plasson USA Electrofusion Couplings have long penetration depths and fusion zones which ensure high quality joints. They are designed, tested and quality controlled in accordance with Plasson's internal standards. Plasson USA Electrofusion Fittings meet or exceed the following standards:

- ASTM D2513
- ISO 8085
- AWWA C906
- ASTM F1055
- ISO 14236
- FM 1613 (FM Approved Fittings Only)
- ASTM F2897



INDUSTRIAL



GAS



MINING



WATER



FIRE
PROTECTION



LANDFILL

PRODUCT DATA

PRODUCT CODE	5901U & 5901B	PRESSURE RATING GAS	125 PSI
PRODUCT DESCRIPTION	Coupling	PRESSURE RATING WATER	200 PSI
PRIMARY DIMENSION	1/2" CTS - 30 IPS	FITTING RAW MATERIAL	PE 4710/PE 100
SECONDARY DIMENSION	N/A	AMBIENT FUSION TEMPERATURE	14 - 113 °F

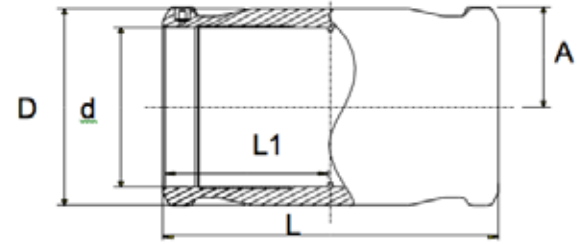

DIMENSIONS

ITEM NUMBER	PIPE SIZE	d inch (mm)	D inch (mm)	L inch (mm)	L1 inch (mm)	A inch (mm)	Ω @ 20°C ohms	FUSE TIME (sec.)	FUSE VOLTS	COOL TIME (min.)	WEIGHT lb (g)
5901U004005	1/2 CTS	0.63 (16.2)	1.38 (35)	2.80 (71)	1.22 (31)	1.50 (138)	3.67	20	40	5	0.13 (57)
5901U004007	3/4 CTS	0.88 (22.5)	1.42 (36)	2.80 (71)	1.34 (34)	1.50 (138)	3.98	35	40	5	0.10 (47)
5901U004010	1 CTS	1.13 (28.8)	1.73 (44)	3.15 (80)	1.54 (39)	1.65 (42)	2.50	30	40	5	0.16 (72)
5901U004013	1 1/4 CTS	1.38 (35.1)	2.20 (56)	3.54 (90)	1.71 (44)	1.85 (47)	1.84	50	40	5	0.27 (122)
5901B004020	2 IPS	2.40 (60.9)	3.23 (82)	4.61 (117)	2.24 (57)	2.24 (57)	1.33	80	40	10	0.55
5901B004030	3 IPS	3.52 (89.4)	4.65 (118.0)	5.87 (149.0)	2.87 (73.0)	2.72 (69.0)	0.832	110	40	10	1.32
5901B004040	4 IPS	4.52 (114.7)	5.51 (140.0)	6.46 (164.0)	3.15 (80.0)	3.19 (81.0)	0.598	140	40	10	1.72
5901B004060	6 IPS	6.63 (168.5)	8.15 (207.0)	7.99 (203.0)	3.94 (100.0)	4.28 (109.0)	0.692	400	40	10	4.08
5901B004080	8 IPS	8.64 (219.4)	11.0 (280.0)	9.41 (239.0)	4.65 (118.0)	5.51 (140.0)	0.673	600*	40	20*	10.9
5901B004100	10 IPS	10.77 (273.5)	13.4 (340.0)	10.8 (275.0)	5.33 (135.5)	6.37 (162.0)	0.557	900	40	30	16.3
5901B003120	12 IPS	12.77 (324.3)	15.3 (388.0)	11.2 (284.0)	5.51 (140.0)	7.36 (187.0)	0.512	1020	40	45	17.8
5901B003140	14 IPS	14.00 (355.5)	16.9 (430.0)	11.0 (280.0)	5.51 (140.0)	7.95 (202.0)	0.521	1320*	40	45*	22.9
5901B003160	16 IPS	16.00 (406.6)	19.1 (485.0)	11.7 (297.0)	5.83 (148.0)	8.96 (227.5)	0.513	1800	42	30	31.3
5901B003180	18 IPS	18.00 (457.0)	21.4 (543.0)	12.2 (310.0)	6.10 (155.0)	10.0 (254.0)	0.726	1140 (x2)	40	30	31.3
5901B003200	20 IPS	20.00 (508)	23.74 (603.0)	14.8 (376.0)	7.40 (188.0)	12.5 (317.0)	0.519*	1500 (x2)	40	45	50.9
5901B003220	22 IPS	22.00 (558.8)	26.53 (674.0)	14.8 (376.0)	7.40 (188.0)	12.5 (317.0)	0.519*	1620 (x2)	40	60	70.5
5901B003240	24 IPS	24.00 (609.6)	28.34 (720.0)	16.5 (418.0)	8.23 (209.0)	14.0 (355.5)	0.518	1800 (x2)	40	60	99.2
5901B003280	28 IPS	28.00 (711.2)	33.60 (853.0)	18.58 (472.0)	9.29 (236.0)	15.74 (400.0)	0.519	2700 (x2)	42	70	139
5901B003300	30 IPS	30.00 (762.0)	36.69 (932.0)	19.69 (500.0)	9.84 (250.0)	16.89 (429.0)	0.498	2640 (x2)	42	65	193

*new design - revised 2014-2015

