

ELECTROFUSION BRANCH SADDLES

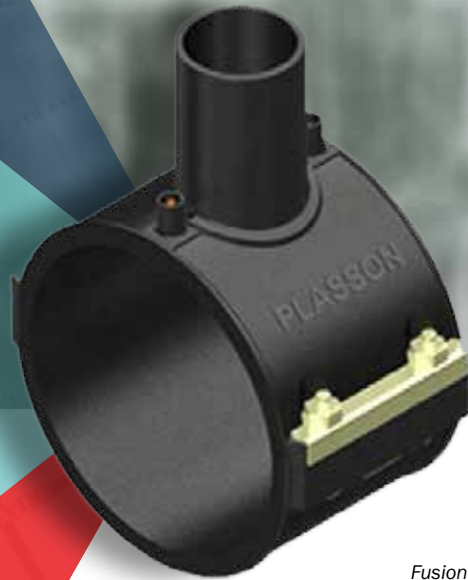

PE4710 / PE100

3" IPS" - 12" IPS Main x 2" and 3" Outlets
40 Volts, 4.0MM Pin with Universal Barcode

*Fusion and Cooling times are clearly marked on the barcode of every fitting.
This information may also be obtained with the barcode reader.*

Plasson USA Electrofusion Fittings are specifically designed for reliable, high performance pipe joining and long system life. The Plasson automated Electrofusion system has been proven to be the most economical due to the low potential for operator error.

Plasson USA Electrofusion Branch Saddles are supplied with a dedicated strap/clamp to assure proper compression during the fusion process. They are designed, tested and quality controlled in accordance with Plasson's internal standards. Plasson USA Electrofusion Fittings meet or exceed the following standards:

- ASTM D2513 ASTM F1055 ASTM F2897
- ISO 8085 ISO 14236
- AWWA C906 FM 1613 (FM Approved Fittings Only)



INDUSTRIAL



GAS



MINING



WATER



FIRE
PROTECTION



LANDFILL

PRODUCT DATA

PRODUCT CODE	PRODUCT DESCRIPTION	PRIMARY DIMENSION	SECONDARY DIMENSION	PRESSURE RATING GAS	PRESSURE CLASS (WATER)	FITTING RAW MATERIAL	AMBIENT FUSION TEMPERATURE
5958BB	Branch Saddle	3 IPS - 12 IPS	2 IPS - 3 IPS	125 PSI	160 PSI	PE 4710/PE 100	14 - 113 °F

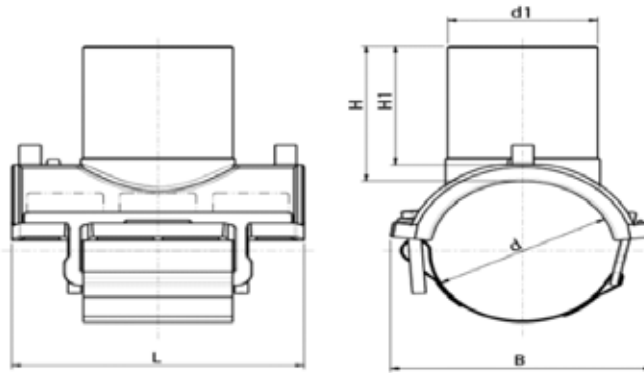

DIMENSIONS

ITEM NUMBER	MAIN PIPE SIZE d	OUTLET SIZE d1	B		H		H1		L		WEIGHT	
			(inch)	(mm)	(inch)	(mm)	(inch)	(mm)	(inch)	(mm)	(lbs)	g
5958BB03030020	3 IPS	2 IPS	4.76	120.9	3.31	84.1	3.31	84.1	4.65	118.1	1.29	585
5958BB03030030	3 IPS	3 IPS	5.48	139.2	3.49	88.6	3.49	88.6	6.93	176.0	1.29	585
5958BB03040020	4 IPS	2 IPS	6.26	159.0	3.3	83.8	3.3	83.8	4.65	118.1	1.55	703
5958BB03040030	4 IPS	3 IPS	6.16	156.5	3.49	88.6	3.49	88.6	6.93	176.0	2.18	989
5958BB03060020	6 IPS	2 IPS	8.5	215.9	3.29	83.6	3.29	83.6	4.65	118.1	1.78	808
5958BB03060030	6 IPS	3 IPS	6.84	173.7	3.49	88.6	3.49	88.6	6.93	176.0	2.2	998
5958BB03080020	8 IPS	2 IPS	7.08	179.8	3.31	84.1	3.31	84.1	6.93	176.0	1.93	876
5958BB03080030	8 IPS	3 IPS	7.08	179.8	3.48	88.4	3.48	88.4	6.93	176.0	2.09	948
5958BB03100020	10 IPS	2 IPS	7.11	180.6	3.31	84.1	3.31	84.1	6.93	176.0	2.13	966
5958BB03100030	10 IPS	3 IPS	7.11	180.6	3.49	88.6	3.49	88.6	6.93	176.0	2.35	1066
5958BB03120020	12 IPS	2 IPS	7.11	180.6	3.31	84.1	3.31	84.1	6.93	176.0	2.13	966
5958BB03120030	12 IPS	3 IPS	7.11	180.6	3.49	88.6	3.49	88.6	6.93	176.0	2.35	1066

WELDING PARAMETERS

ITEM NUMBER	MAIN PIPE SIZE d	OUTLET SIZE	Ω @ 20°C ohms	FUSE TIME SECONDS	NOMINAL FUSION VOLTAGE (Volt)	COOL TIME MINUTES
5958BB03030020	3 IPS	2 IPS	2.72	100	38	10
5958BB03030030	3 IPS	3 IPS	1.42	070	40	10
5958BB03040020	4 IPS	2 IPS	3.57	150	34	10
5958BB03040030	4 IPS	3 IPS	1.53	090	40	10
5958BB03060020	6 IPS	2 IPS	8.73	240	40	10
5958BB03060030	6 IPS	3 IPS	2.63	270	37	10
5958BB03080020	8 IPS	2 IPS	2.63	310	38	10
5958BB03080030	8 IPS	3 IPS	2.63	310	38	10
5958BB03100020	10 IPS	2 IPS	2.97	280	40	10
5958BB03100030	10 IPS	3 IPS	2.97	280	40	10
5958BB03120020	12 IPS	2 IPS	2.63	460	32	15
5958BB03120030	12 IPS	3 IPS	2.63	460	32	15

